

DIMENSION TABLE

MODEL NUMBER	REPLACEMENT LOAD SENSOR	CAPACITY LBS [KG]	WIDTH IN [MM]	SEATED HEIGHT IN [MM]	FOOTPRINT IN [MM]
HIBSX-24SS-PBZ-150LB	HIPBZ-44LB-L1.25FT	150 [68]	24.00 [609.6]	2.25 [57.2]	18.00 [457.2]
HIBSX-24SS-PBZ-400LB	HIPBZ-110LB-L1.25FT	400 [181]			
HIBSX-24SS-PBZ-800LB	HIPBZ-220LB-L1.25FT	800 [363]			
HIBSX-24SS-PBZ-1300LB	HIPBZ-440LB-L1.25FT	1300 [590]			

REV.	ECO/DDC	DESCRIPTION	DATE	DRAFT	CHECK	APVD
A	---	RELEASED.	6-28-23	V.J.C.	J.M.	V.J.C.

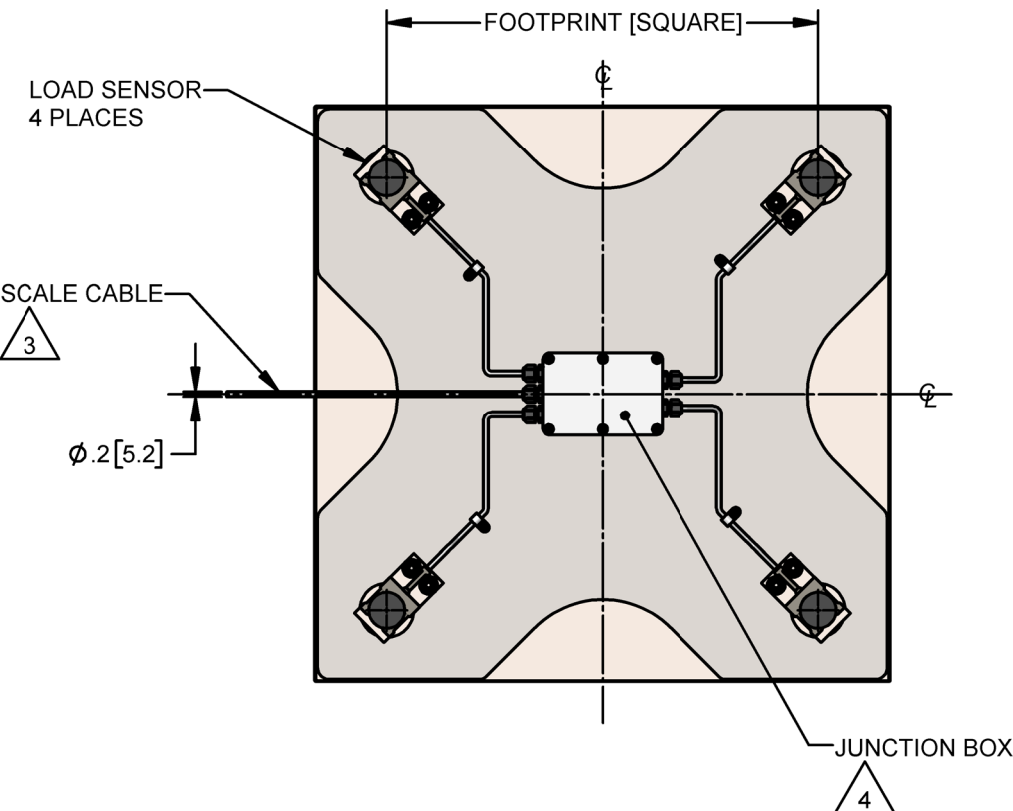
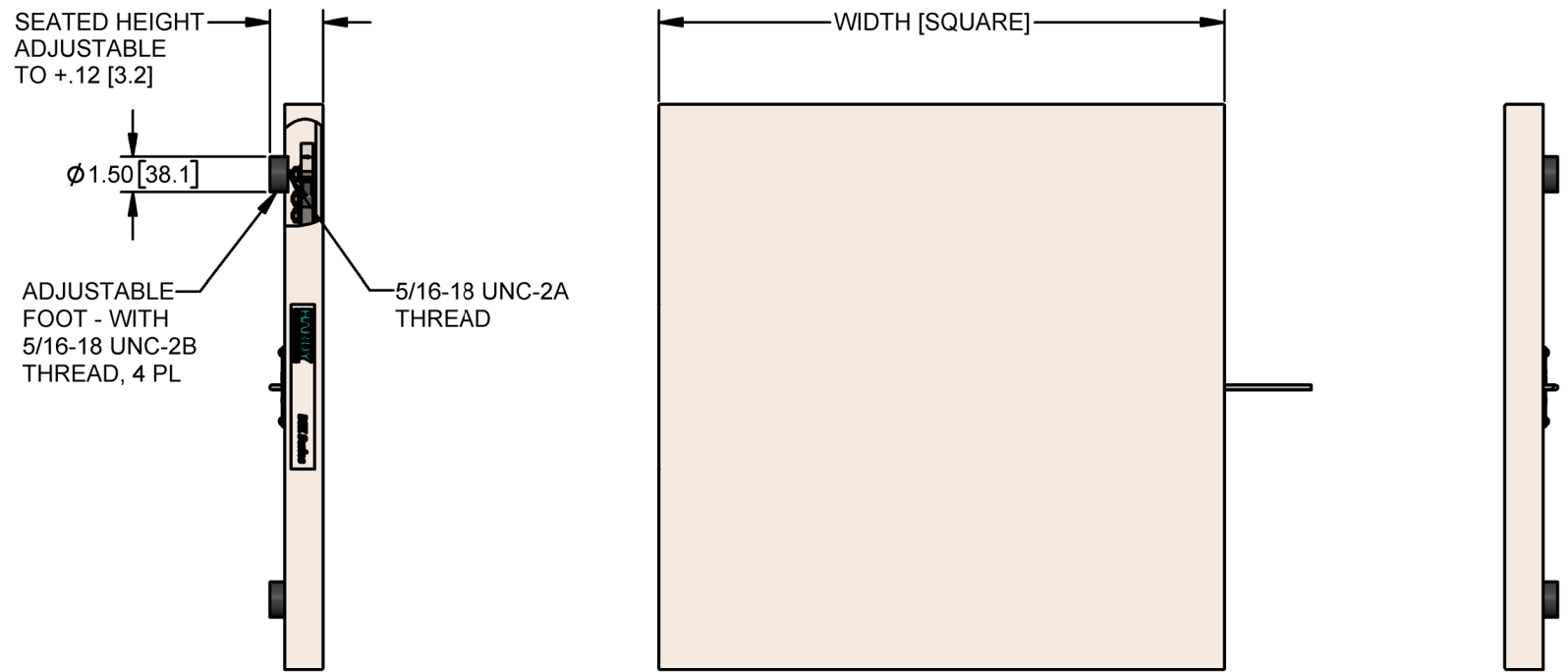

5 SEE SHEET 2 FOR JUNCTION BOX WIRING INFORMATION.

4 IT SUMMING CARD, HARDY PART NUMBER HI6011IT-SC1, IS INSTALLED WITHIN JUNCTION BOX.

3 SCALE CABLE TYPE: 8 CONDUCTOR, 24AWG, SHIELDED, WITH DRAIN WIRE
 CABLE LENGTH: 15 FEET [4.6 METER]
 CABLE JACKET: PVC
 CABLE WIRE COLOR CODE FLAG LABEL LOCATED ON END OF CABLE:

EXCITATION +	RED
SENSE +	BLUE
SIGNAL +	GREEN
SIGNAL -	WHITE
SENSE -	BROWN
EXCITATION -	BLACK
C2 +	GRAY
C2 -	VIOLET
SHIELD (DRAIN)	YELLOW (OR CLEAR)

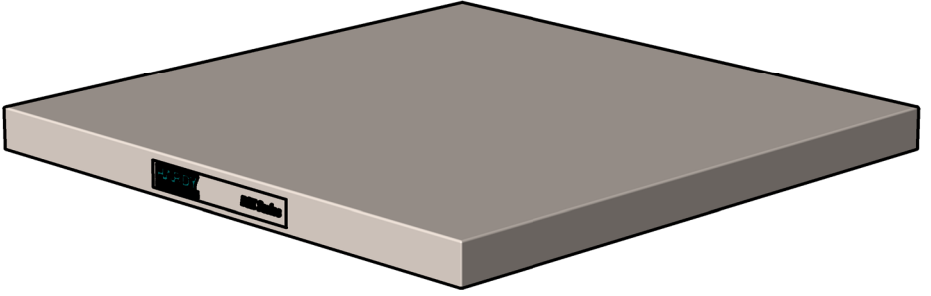

HIBSX-24 PBZ BENCH SCALE SERIES

2. SCALE MATERIAL IS TYPE 304 STAINLESS STEEL. SCALE LOAD SENSOR MATERIAL IS TYPE 17-4PH STAINLESS STEEL.

1. SEE HARDY PROCESS SOLUTIONS WEB SITE FOR ADDITIONAL INSTALLATION AND WIRING INFORMATION.

NOTES: UNLESS OTHERWISE SPECIFIED

PROPRIETARY NOTICE
 ALL DATA AND INFORMATION CONTAINED IN OR DISCLOSED BY THIS DOCUMENT IS CONFIDENTIAL AND PROPRIETARY INFORMATION OF HARDY PROCESS SOLUTIONS AND ALL RIGHTS THEREIN ARE EXPRESSLY RESERVED. BY ACCEPTING THIS MATERIAL THE RECIPIENT AGREES THAT THIS MATERIAL AND THE INFORMATION CONTAINED THEREIN IS HELD IN CONFIDENCE AND IN TRUST AND SHALL NOT BE USED, COPIED, REPRODUCED IN WHOLE OR IN PART, NOR ITS CONTENTS REVEALED IN ANY MANNER TO OTHERS, EXCEPT TO MEET THE SPECIFIC PURPOSE FOR WHICH IT WAS DELIVERED.

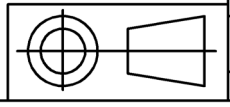

ITEM	QTY	PART NUMBER	DESCRIPTION	COMMENTS
0588-0222 OUTLINE DRAWING, HIBSX-24 PBZ SERIES BENCH SCALES				
UNLESS OTHERWISE SPECIFIED DIMENSIONS ARE IN INCHES [MM] TOLERANCES ARE: FRACTIONS: N/A DECIMALS: .XX = ±.03 [.76] .XXX = ±.010 [.25] ANGLES ±0°, 30°				
CONTRACT NO.		APPROVALS		
DRAWN V. CHULA		DATE 06-20-23		
CHECKED J. MOEN		DATE 06-22-23		
APPROVED V. CHULA		DATE 06-28-23		
ISSUED V. CHULA		DATE 06-28-23		
MATERIAL		PRODUCTION		TITLE OUTLINE DRAWING, HIBSX-24 PBZ SERIES BENCH SCALES
FINISH		DATE		
DO NOT SCALE DRAWING		SIZE D	FSCM 21316	DRAWING NO. 0588-0222
		FILE NAME:0588-0222A1.SLDDRW		SCALE: NONE
		SHEET 1		OF 2

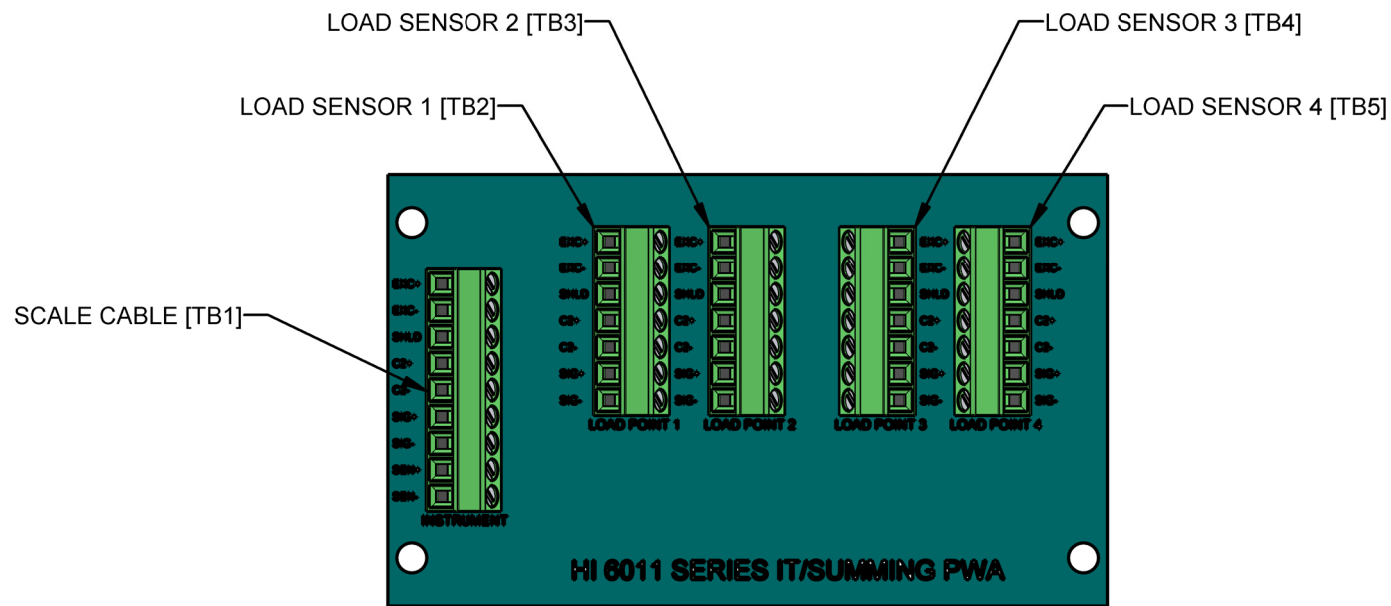

IT SUMMING CARD



HIBSX-24 PBZ BENCH SCALE
[VIEWED FROM BOTTOM SIDE]

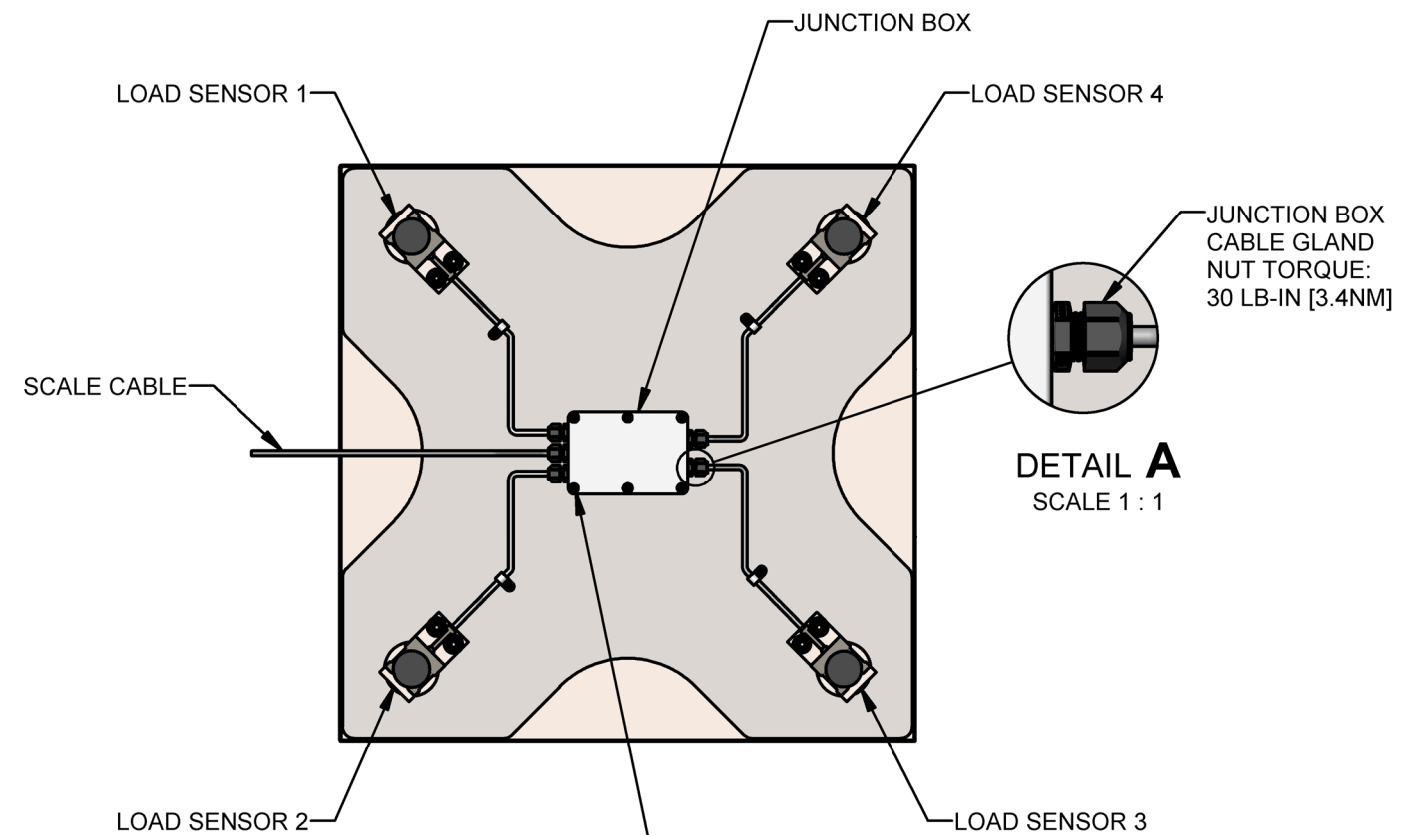

DETAIL A
SCALE 1 : 1

JUNCTION BOX TOP COVER
SCREW TORQUE: 10 LB-IN [1.1NM]

TORQUE TOP COVER SCREWS
PER ORDER SEQUENCE SHOWN
BELOW

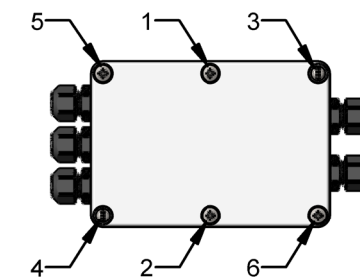

SCALE CABLE WIRING [CONNECTOR TB1]	
EXC +	RED
EXC -	BLACK
SHLD (DRAIN)	YELLOW (OR CLEAR)
C2 +	GRAY
C2 -	VIOLET
SIG +	GREEN
SIG -	WHITE
SEN +	BLUE
SEN -	BROWN

LOAD SENSOR 1 - 4 CABLE WIRING [CONNECTORS TB2 - TB5]	
EXC +	RED
EXC -	BLACK
SHLD (DRAIN)	YELLOW (OR CLEAR)
C2 +	GRAY
C2 -	VIOLET
SIG +	GREEN
SIG -	WHITE

NOTES:

- SCALE CABLE AND LOAD SENSOR CABLES ARE PRE-INSTALLED BY HARDY PROCESS SOLUTIONS.
- CABLE WIRE TIGHTENING TORQUE FOR TERMINAL BLOCKS IS 2 - 4 LB-IN [0.2 - 0.5NM].
- WARNING: DO NOT CONNECT SCALE TO INSTRUMENTS WITH EXCITATION VOLTAGE GREATER THAN 5 VOLTS DC OR SCALE CIRCUIT DAMAGE CAN OCCUR



TITLE
OUTLINE DRAWING, HIBSX-24
PBZ SERIES BENCH SCALES

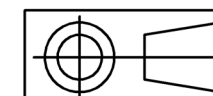

SIZE	FSCM	DRAWING NO.	REV.
D	21316	0588-0222	A
FILE NAME: 0588-0222A1.SLDDRW		SCALE: NONE	SHEET 2 OF 2